

Sold

29 Shoreline Drive, Port Macquarie

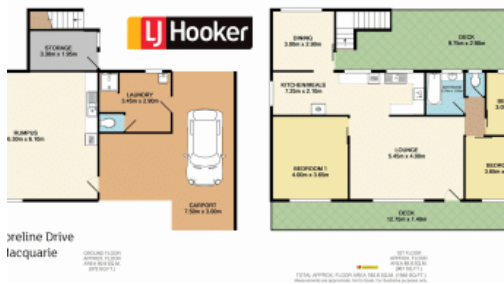

Motivation Paramount

The Owner has now reduced this much loved house to meet the market and achieve a result. Set on the beautiful North Shore, in a caring community, this well configured property offers two living areas.

The main home is upstairs, whilst downstairs could be used for a rumpus room or for a bed sitting area with kitchenette, ideal for a teenage retreat or for a older family member. The options are endless. Only a short walk to the beautiful North Shore break and also the Settlement Point Ferry. It's time to act today and buy 'the blue house'. Call to arrange you inspection. Council Rates \$1,200pa.

The above information provided has been furnished to us by the vendor/s. We have not verified whether or not that information is accurate and do not have any belief in one way or the other in its accuracy. We do not accept any responsibility to any person for its accuracy and do no more than pass it on. All interested parties should make and rely upon their own inquiries in order to determine whether or not this information is in fact accurate.

3 2 2 685 m2

Price	SOLD
Property Type	Residential
Property ID	1378
Land Area	685 m2

Agent Details

Keith Cramp - 0418 633 098

Office Details

Lake Cathie Bonny Hills Real Estate
 SHOP 6 1609 Ocean Dr Lake Cathie
 NSW 2445 Australia
 02 6585 5777

