

Sold

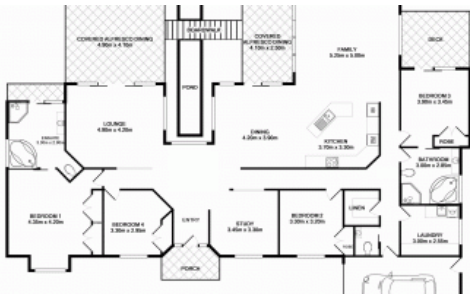

### 7 Edgewater Close, Lake Cathie



### Sold In 15 Days

Magnificently spread over park like grounds, this contemporary designed level residence is perfectly appointed to ensure an idyllic family lifestyle. The residence boasts a resort style gazebo, private in ground pool and stunning timber boardwalk over a feature fish pond. Inside is a display of excellence with separate living, dining and family areas and a stylish kitchen with gloss cupboards, stone benchtops and splashbacks and stainless steel appliances including gas cooktop. With a North facing aspect and extensive use of glass and high ceilings you will appreciate the natural light and cooling sea breezes the home achieves. There are four bedrooms the main offering a king sized ensuite with spa bath whilst the segregated second bedroom has ensuite access to the main bathroom and sliding door access to a timber deck making it ideal for guests. Features include; reverse cycle air conditioning, separate study from the entry foyer, convenience of 3rd WC, internal access from the double garage, ceiling fans, garden shed and advantage of side access. This home is crafted with superior finishes and is truly remarkable. Council Rates: \$2,559 pa.

4 2 2 2,211 m<sup>2</sup>

<b>Price</b>	SOLD
<b>Property Type</b>	Residential
<b>Property ID</b>	1455
<b>Land Area</b>	2,211 m <sup>2</sup>
<b>Floor Area</b>	316 m <sup>2</sup>

### Agent Details

Keith Cramp - 0418 633 098

### Office Details

Lake Cathie Bonny Hills Real Estate  
 SHOP 6 1609 Ocean Dr Lake Cathie  
 NSW 2445 Australia  
 02 6585 5777



*The above information provided has been furnished to us by the vendor/s. We have not verified whether or not that information is accurate and do not have any belief in one way or the other in its accuracy. We do not accept any responsibility to any person for its accuracy and do no more than pass it on. All interested parties should make and rely upon their own inquiries in order to determine whether or not this information is in fact accurate.*